

## Anti-slip - High performance ANTI-SLIP LATTAM

**ANTI-SLIP LATTAM Arelec Solution** is ideal for fixing to all metal surfaces : paint booths, cold rooms, modular buildings, IPNs, shelving, vehicles, etc.

What's more, its magnetic strength means it can **withstand high speeds**. But its main feature is its rubber coating, which **eliminates slippage** during vertical fixings. ANTI-SLIP eliminates the need to drill holes, makes installation and removal easier and leaves no scratches or marks on your supports.



*Anti-slip LATTAM white*



*Anti-slip LATTAM grey*



*Anti-slip LATTAM black*

**High-performance ANTI-SLIP LATTAM** are made up of **neodymium** magnets, entirely coated with an ANTI-SLIP synthetic polymer. There are also several rectangular or cylindrical sizes, for gluing or screwing on depending on the model.

Model	Thickness (mm)	Thread	Typical load-bearing capacity (kg)	Color	Reference	Quantity per smallest packaging
Cylindrical Diam 31	6	M5	7.5	Grey	<b>0335054</b>	100
				White	<b>0335055</b>	100
				Black	<b>0335056</b>	100
Cylindrical Diam 43	6	M4	8.5	Grey	<b>0335051</b>	100
				White	<b>0335052</b>	100
				Black	<b>0335082</b>	100
Cylindrical Diam 66	8	M6	18	Grey	<b>0335057</b>	56
				White	<b>0335058</b>	56
				Black	<b>0335059</b>	56
					<b>0335066</b>	56
Cylindrical Diam 88	8.5	M6	42	Black	<b>0335030</b>	50
	8.5	M5	42	White	<b>0335062</b>	50
				Black	<b>0335029</b>	50

## HIGH PERFORMANCE ANTI-SLIP LATTAM



*Diameter 31*

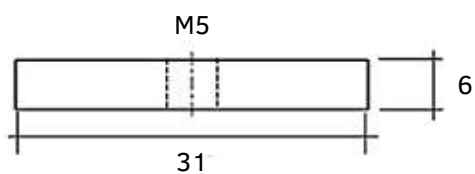

*Diameter 43*

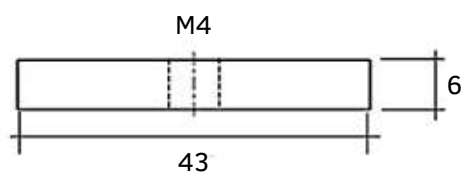

*Diameter 66*

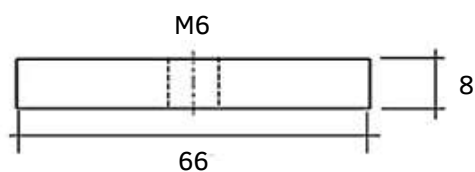

*Diameter 88*

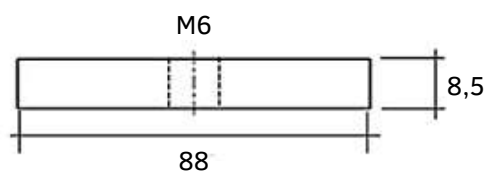

## Anti-slip - Rectangular ANTI-SLIP LATTAM

**ANTI-SLIP LATTAM Arelec Solution** is ideal for fixing to all metal surfaces : paint booths, cold rooms, modular buildings, IPNs, shelving, vehicles, etc.

What's more, its magnetic strength means it can **withstand high speeds**. But its main feature is its rubber coating, which **eliminates slippage** during vertical fixings. ANTI-SLIP **eliminates drilling**, makes installation and removal easier and leaves **no scratches** or marks on your supports.



*Anti-slip LATTAM for gluing*



*Anti-slip LATTAM clip-on*



*Anti-slip LATTAM screw-on*

**ANTI-SLIP LATTAM** consists of ferrite magnets bonded to a metal plate and overmoulded with an ANTI-SLIP elastomer. There are several sizes that can be either **glued**, **clipped** or **screwed** on, depending on the model.

Model	Dimensions (mm)*	Typical load-bearing capacity (kg)	Reference	Quantity per small packaging
Rectangular to glue-on	60 x 30 x 7.5	3.5	<b>0335005</b>	50
	60 x 60 x 7.5	6.5	<b>0335014</b>	50
	90 x 30 x 7.5	5	<b>0335012</b>	200
	120 x 30 x 7.5	6.5	<b>0335008</b>	50
	120 x 60 x 7.5	13	<b>0335023</b>	50
Rectangular clip-on	60 x 20 x 7.5	2.2	<b>0335003</b>	50
Rectangular screw-on	120 x 30 x 7.5	5	<b>0335074</b>	50
	120 x 30 x 7.5	5	<b>0335024</b>	50

*\*Other sizes available*

## RECTANGULAR ANTI-SLIP LATTAM

 *To stick: Réf 0335005*

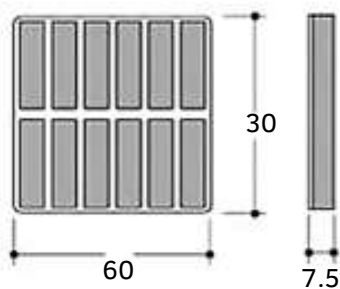

 *To stick: Réf 0335014*

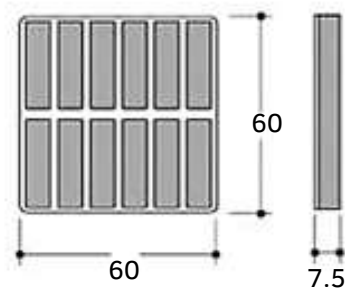

 *To stick: Réf 0335012*

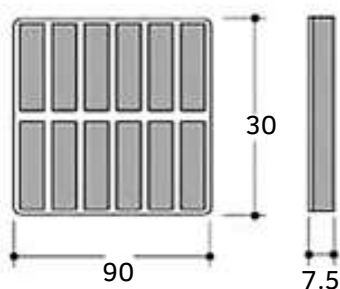

 *To stick: Réf 0335008*

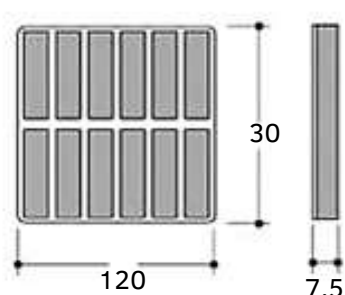

 *To stick: Réf 0335011*

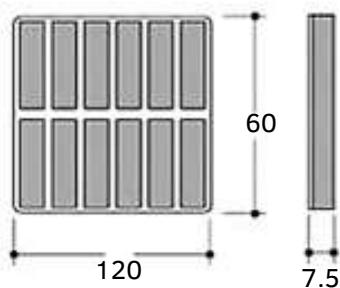

 *Screw-on: Réf 0335013*

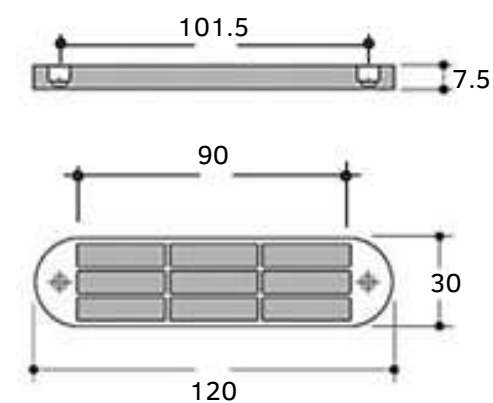

 *Clip-on: Réf 0335003*

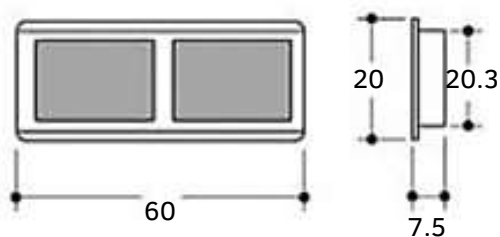

 *Clip-on: Réf 0335002*

